

Rauduks OÜ	koostas:	A. Murde	tähis:	P07J12
Fire door TU-1 EI 30	kinnitas:	A. Orumaa	lehti:	1
	kehtib alates:	01.06.2015	leht:	1

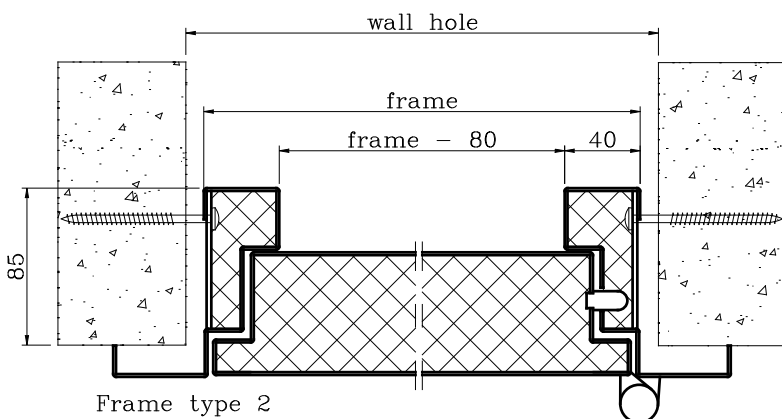

Applications:	
Internal and external (fire) doors	
Features:	
Max. width of the frame	1200 mm
Max. height of the frame	2400 mm
Steel sheet	- cold rolled
	- galvanized
Thickness	1,2 mm
Soundproof	38 dB
Fire resistance	EI 30
Threshold	1,5 mm stainless
Finish	Powder Coating
Air Vent	no
Glass Panel	no
Peephole	yes
Lock types	all common types

Threshold type

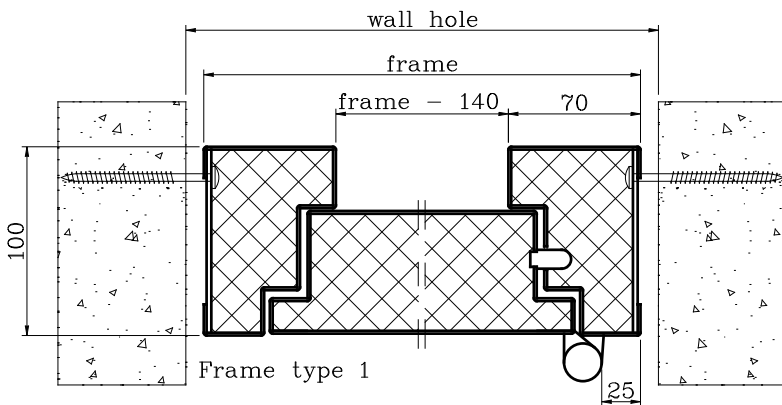
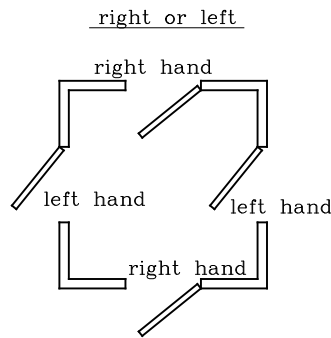
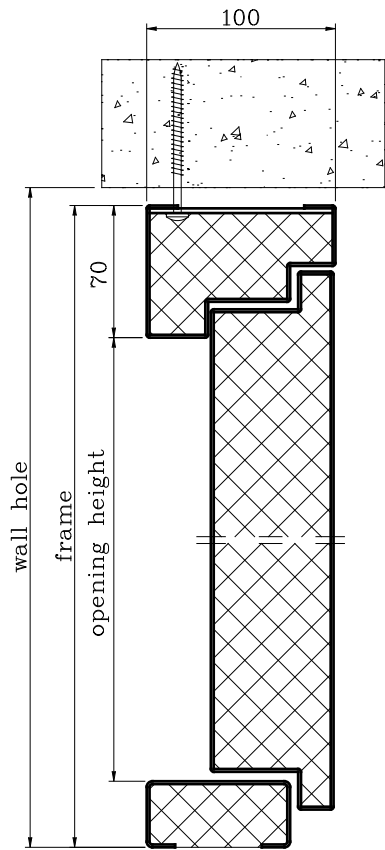